

MXL (.080") Pitch Timing Belt Pulleys For 1/8" Belts Type CF and HF

(Gold or Clear) Anodized Aluminum Alloy

ALL DIMENSIONS IN INCHES

Code Number	# of Teeth	Pulley Type	Pulley Pitch Diam	Pulley Diam	Flange Diam +/- .020"	Cap Diam +/- .015"	Overall Width +/- .010"	Face Width +/- .010"	Belt Width +/- .005"	Cap Width +/- .015"	Setscrew Location +/- .015"	Setscrew Size	Stock Bore Diam + .001/- .000"
10-MXL-012	10	CF	.255	.235	.425	.425	.437	.201	.156	.236	.118	4-40*	1/8
11-MXL-012	11	CF	.280	.260	.450	.450						4-40*	1/8
12-MXL-012	12	CF	.306	.286	.480	.480						4-40*	1/8
14-MXL-012	14	CF	.357	.337	.530	.530						4-40*	1/8
15-MXL-012	15	CF	.382	.362	.555	.555						6-40*	3/16
16-MXL-012	16	CF	.407	.387	.580	.580						6-40*	3/16
18-MXL-012	18	CF	.458	.438	.635	.635		.208		.229	.115	6-40**	1/4
20-MXL-012	20	CF	.509	.489	.685	.685						6-40**	1/4
21-MXL-012	21	CF	.535	.515	.710	.710						6-40**	1/4
22-MXL-012	22	CF	.560	.540	.740	.740						6-40**	1/4

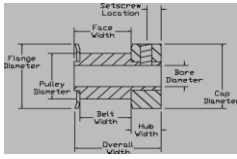

Type CF

ALL DIMENSIONS IN INCHES

Code Number	# of Teeth	Pulley Type	Pulley Pitch Diam	Pulley Diam	Flange Diam +/- .020"	Hub Diam +/- .015"	Overall Width +/- .010"	Face Width +/- .010"	Belt Width +/- .005"	Hub Width +/- .015"	Setscrew Location +/- .015"	Setscrew Size	Stock Bore Diam + .001/- .000"
18-MXL-012	18	HF	.458	.438	.635	.312	.484	.260	.156	.224	.112	6-40**	3/16
20-MXL-012	20	HF	.509	.489	.685	.364						6-40**	3/16
21-MXL-012	21	HF	.535	.515	.710	.390						6-40**	3/16
22-MXL-012	22	HF	.560	.540	.740	.390						6-40**	3/16
24-MXL-012	24	HF	.611	.591	.790	.442	.515			.255	.128	6-40**	1/4
28-MXL-012	28	HF	.713	.693	.895	.494						6-40**	1/4
30-MXL-012	30	HF	.764	.744	.945	.546						8-32**	1/4
32-MXL-012	32	HF	.815	.795	1.000	.598						8-32**	1/4
36-MXL-012	36	HF	.917	.897	1.105	.676						8-32**	1/4
40-MXL-012	40	HF	1.019	.999	1.210	.754	.531	.276				8-32**	1/4
42-MXL-012	42	HF	1.070	1.050	1.260	.806						8-32**	1/4
44-MXL-012	44	HF	1.120	1.100	1.315	.858						8-32**	1/4
48-MXL-012	48	HF	1.222	1.202	1.420	.936						8-32**	1/4
60-MXL-012	60	HF	1.528	1.508	1.730	1.222						8-32**	1/4

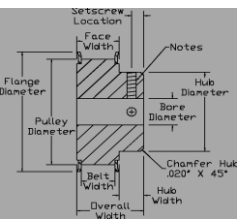

Type HF

P/N Construction: (Code Number) (Bore Diameter) (Type)(Material Code)

PULLEY DIAMETER TOLERANCES	NOTES
10 - 40 Teeth = +.002 / -.000	* One (1) setscrew furnished.
41 - 60 Teeth = +.003 / -.000	** Two (2) setscrews furnished at 90 degrees.
MXL Working Depth = .026"	

Ph: (217) 428-9043
Fx: (877) 1 FAX DSI



Email: info@DSIpulleys.com
Website: www.DSIpulleys.com